

SIDE CROSS SECTION VIEW

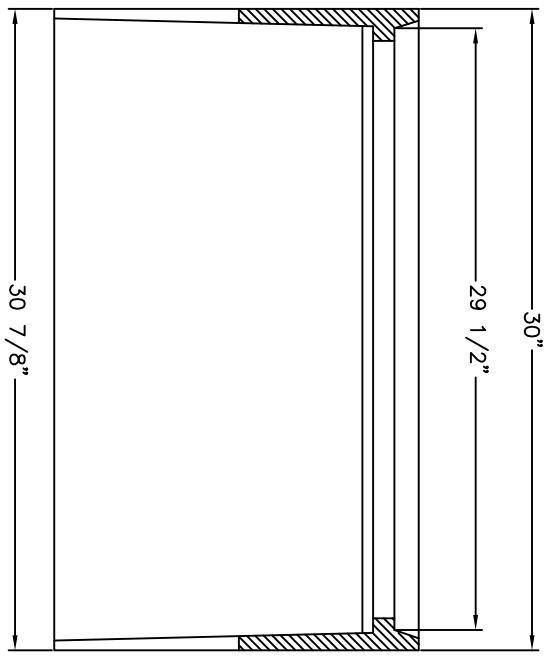

END CROSS SECTION VIEW

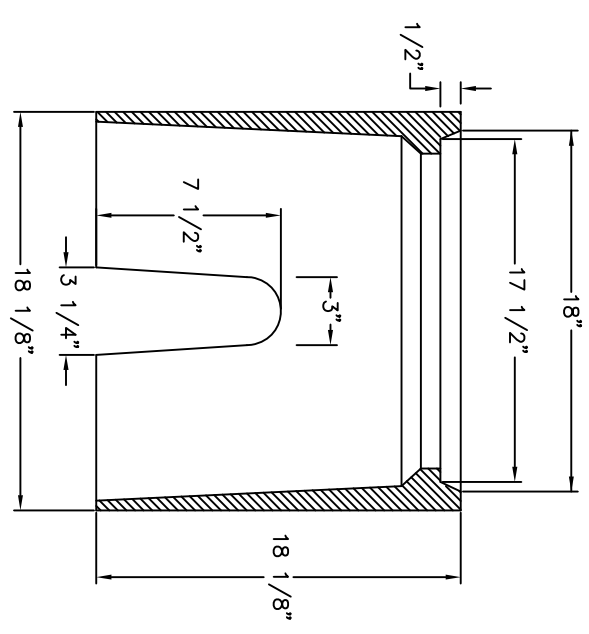

PLAN VIEW
(COVER TOP AND BOTTOM)

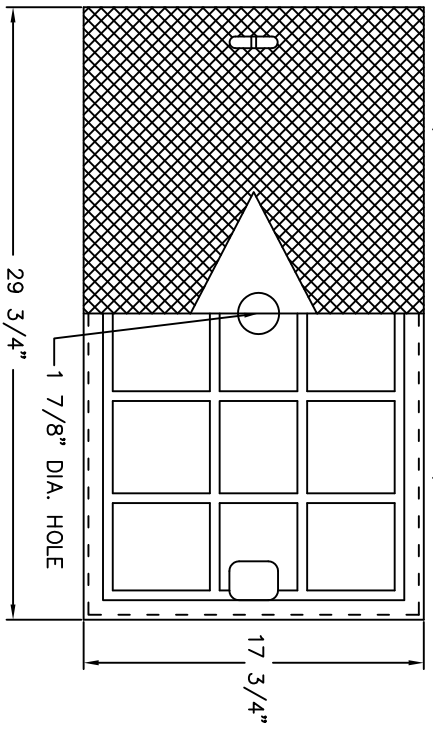

- NOTES:
- A. METER BOX BODY AND LID SHALL BE MADE OF CAST IRON, RATED ASTM A-48, CLASS - 30B.
 - B. APPROXIMATE METER BOX AND COVER WEIGHT: 260 LB.
 - C. 7" MINIMUM OF CLEAN STONE TO BE PLACED UNDER BOX.
 - D. WATER METER BOX SHALL BE SIGMA CORP. MB-2202T METER BOX AND LID OR APPROVED EQUAL.
 - E. NON-TRAFFIC LOAD RATED.

CITY OF HIGH POINT
NORTH CAROLINA
ENGINEERING SERVICES DEPARTMENT

APPROVED FEBRUARY 4, 2007

.....
DIRECTOR

ISSUED 02-01-07
REVISIONS

STANDARD DRAWING FOR

1 1/2" AND 2" WATER METER BOX

FOR USE WITH 1 1/2" AND 2" WATER SERVICES

1.5_2WMBX.DWG

205.00

SHEET 1 OF 1